



**APOLLO**

FABRICATION GROUP PTY LTD

---

2023 CORPORATE PROFILE





# ABOUT

---

## AN AUSTRALIAN MANUFACTURING SUCCESS STORY

Founded in 2000, **Apollo Fabrication Group Pty Ltd (Apollo)** is an Australian owned and operated family business managed from their headquarters in Young, NSW.

Having started out manufacturing specialist waste management equipment, the business has evolved to become a leader in the design, fabrication and installation of large, complex structural steel for the leading names in Australia's construction industry.





# MEET THE LEADERSHIP TEAM

APOLLO IS LED BY A TEAM OF EXPERIENCED AND HIGHLY QUALIFIED INDUSTRY LEADERS WITH MANY YEARS OF EXPERIENCE DELIVERING COMPLEX STEEL CONSTRUCTION PROJECTS.

## TECHNICAL EXPERTS IN STEEL



**Nathan Jackson**  
Sales/Finance Director



**Caleb Jackson**  
Operations Director



**Hayden Ferguson**  
Estimating Manager



**Brett Kennard**  
Senior Project Manager



**Danhill Bansil**  
Drafting Manager



**Paul Brown**  
Site Manager

# THE APOLLO STORY

SO FAR...

2000

## FOUNDED BY W.A FARMER

A farmer for most of his life, Terry Jackson spotted an opportunity to manufacture specialised waste handling equipment for agriculture and industry.

2006

## FROM LITTLE THINGS...

After building their capabilities on smaller projects, Apollo won it's first major project as part of the team building New Creation Church in Canberra.

2003

## OPPORTUNITY KNOCKS

Terry, his wife and two boys packed up to seize the opportunities in regional NSW, moving to Young. His sons Caleb & Nathan joined the growing business.

2007 - 2009

## ...BIG THINGS GROW

Word of mouth attracted more complex architectural design projects like Warragamba Dam, The Scots College, SCG Trust Office & Caringbah High.



WE'RE LOOKING FORWARD TO THE **NEXT CHAPTER.**

2015 - 2018

**DOUBLING PRODUCTION FACILITY**

Apollo's plant grew to 2400sqm and they began global steel importing. Projects include Hornsby PCYC, Wellington Jail, Norwest Hospital, Parramatta Leagues Club, UTS Central & Dubbo Hospital.

2015 - 2018

**EQUIPPED FOR CONTINUED GROWTH**

Apollo has built a foundation to handle even larger projects including the iconic Sirius Building, a landmark development alongside Sydney Harbour Bridge.

2010 - 2014

**BUILDING LOCAL MANUFACTURING**

Apollo invested in a 2200sqm facility to enable major projects like Sydney Airport (T1), Emmanuel Baptist Church, Bunnings, Newington College, Coles, Royal Prince Alfred Hospital and Sikorsky.

2019 - 2022

**AUTOMATION & EDUCATION**

Apollo invested in state-of-the-art automation tools, a purpose built 3500sqm training facility and new 600sqm office, Projects include Barker College, Ashfield Aquatic Centre, Wagga Hospital, Greenacre Processing Plant and more.





# OUR DIFFERENCE

**At Apollo our passion is tackling the most complex steel challenges in construction.**

As your trusted partner, we collaborate with you to win, design and execute successful projects. Here's how.

NEPEAN  
ARTS CENTRE

## Capacity

With a team of industry experts and a world-class local manufacturing facility, we are equipped to deliver major steel structures from design and sourcing to logistics and financial strength.

## Design

Whether architectural or structural engineering, we collaborate with architects, engineers, builders and specialist trades people to create functional, buildable and beautiful solutions.

## Solution

While steel may only be part of your puzzle, we invest the time to understand your broader vision and take ownership of our deliverables from start to finish - no passing the buck.





**Quality**

Quality is at the heart of everything we create. Our processes are backed by the industry leading ISO certifications for the provision of steel design, fabrication and installation.



**CAPACITY**

With a laser focus on the design, fabrication, coating and installation of complicated structural and architectural steelwork, we have the in-depth expertise to bring your vision to life.



**TRACK RECORD**

Having worked on hundreds of projects since 2000, we understand how to deliver flawless quality, precise engineering and seamless installation on time and on budget.



**PARTNERSHIP**

Apollo partners with tier one construction companies on iconic projects across Australia. As well as our in-house experts we have a trusted network of specialist partners to get the job done.



**PEOPLE**

In our 600sqm training facility, we offer apprenticeships and skills development to attract, retain and upskill specialised talent from project managers and designers to welders and painters.



# SOLUTIONS

CAPACITY. DESIGN.  
SOLUTIONS.

From sweeping curved roofs and high rise lift shafts to striking stairs, structural foundations, grand architectural features and everything in between, **with Apollo the only limit is your imagination.**

With a reputation for quality built over two decades, we have a proven track record of commercial, industrial, retail and residential projects across sectors spanning healthcare, education, defence, government, leisure and community.

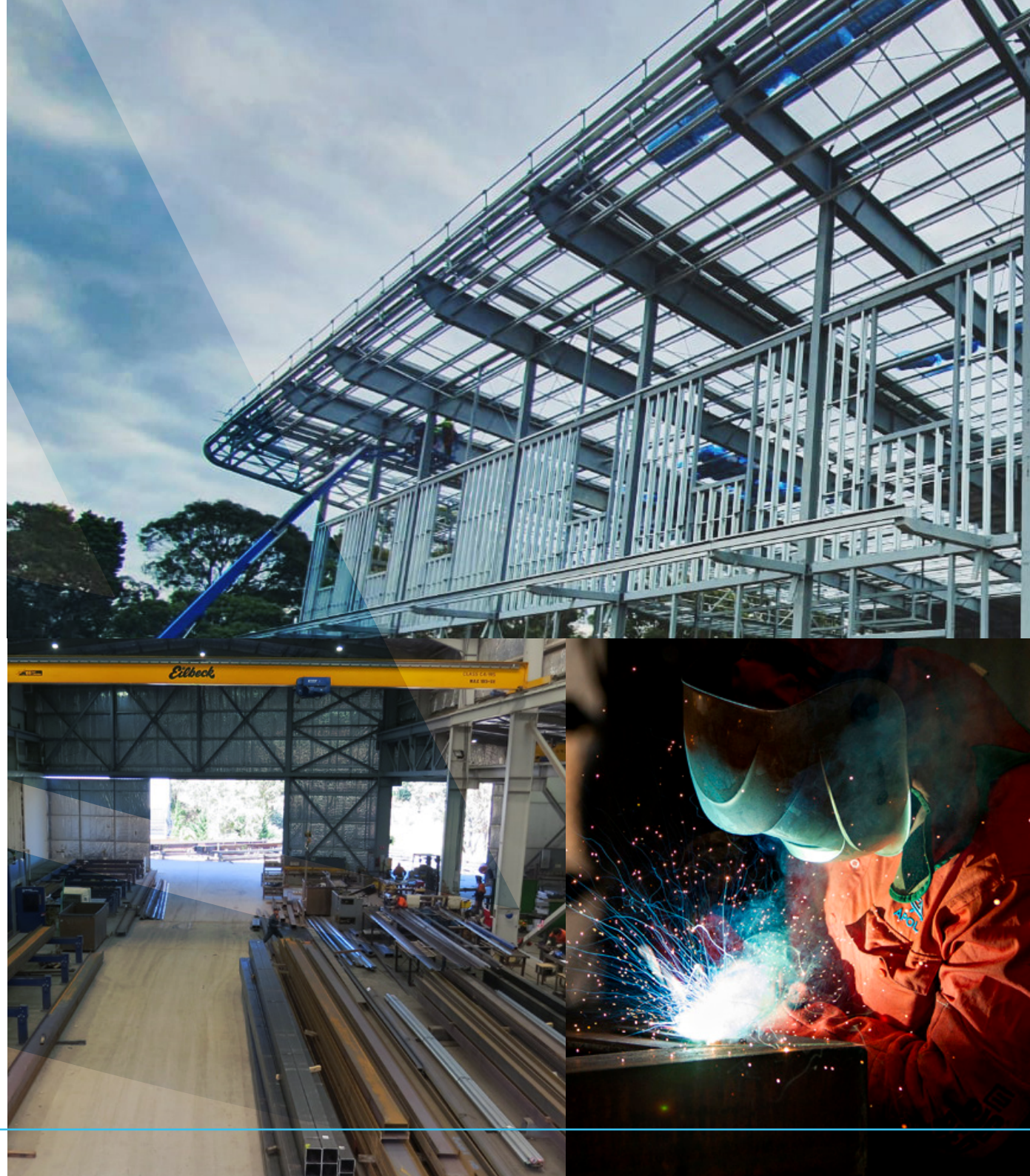





## OUR SUITE OF SPECIALIST SERVICES INCLUDE:

- Design & Drafting
- Steel Processing
- Steel Fabrication
- Steel Installation
- Surface Treatment
- Cranes & Logistics
- Protective & Fire Rated
- Coatings
- Shop Detailing

## OUR EXPERT DELIVERY TEAMS INCLUDE:

- Project Managers & Coordinators
- Site & Construction Managers
- Leading hands
- Estimators
- Safety Officers
- Technical Draftspeople
- Expert fabricators, painters, riggers, sand blasters, welders, coaters, installers, boilermakers etc.
- And hands-on Directors.



# WORLD CLASS FACILITY

CONTEMPORARY DESIGN.  
STATE-OF-THE-ART  
MANUFACTURING.

**Apollo** has invested in a state-of-the-art manufacturing plant where we design, manufacture, coat, store and deliver our steel structure. **For you, it means capacity and quality you can depend on:**

- 3,500 sqm workshop – manufacturing, welding, blasting, coating
- 10,000 sqm storage yard – raw material and structure storage
- 600 sqm office – design, engineering and project management
- Cutting edge construction and automation tools for accuracy and efficiency
- Capacity to produce hundreds of tonnes of steelwork per week









# SAFETY & QUALITY AT EVERY STAGE

For everyone at **Apollo**, **safety and quality is a core part of their responsibility**. We call this company-wide quality control. Much more than simply inspecting for errors in finished parts, our approach is to **build in quality and safety at every stage**, with a mindset of continual improvement.

With strictly standardised processes across our supply chain, **we are able to identify and resolve issues quickly, while maintaining consistent quality, safety and timeliness**. With our own manufacturing facility, equipment and team, we have total control over the operations and output, **so we take full accountability for quality and safety**.

WE OFFER ONGOING WORK HEALTH AND SAFETY (WHS) TRAINING AND DEVELOP A TAILORED SAFETY PLAN FOR EVERY PROJECT TO MAXIMISE THE SAFETY OF OUR EMPLOYEES, PARTNERS AND SITE VISITORS.



[WWW.JAS-ANZ.ORG/REGISTER](http://WWW.JAS-ANZ.ORG/REGISTER)



ISO 9001:2015  
**Quality Management  
Systems**

ISO 14001:2015  
**Environmental  
Management  
Systems**

ISO 45001:2018  
**Occupational Health  
& Safety**



Australian Welding Institute  
Certification - Working Towards Accreditation  
**CC3 Level for AS/NZs 5131**



# PROJECT GALLERY

---

**Apollo specialises in delivering large, complex structural steel for top tier builders and developers of industrial, commercial, retail and high-rise residential projects across Australia.**

From architectural masterpieces to engineering excellence, we have proven results in sectors spanning healthcare, education, defence, government, leisure and community.

---

**PROJECT ON THIS PAGE:  
HABERFIELD ROWING CLUB**

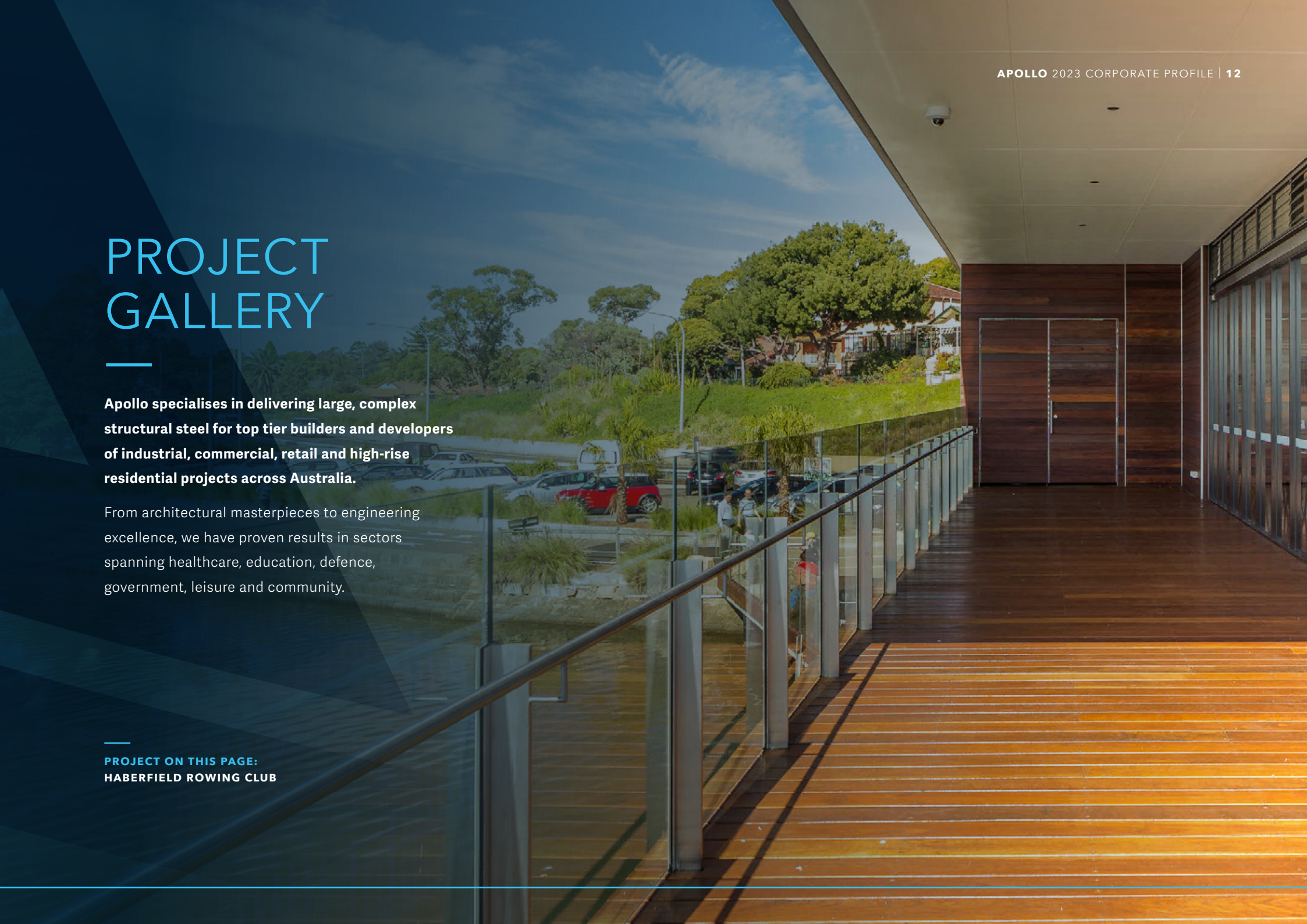



PROJECT:

# TJX WAREHOUSE

MARSDEN PARK, NSW





# TJX WAREHOUSE

STATE-OF-THE-ART OFFICE,  
AWNINGS & WAREHOUSE

**TJX Distribution Centre** is one of the industrial facilities completed by our construction partner FDC Construction & Fitout. It is a highly sophisticated site designed for large-scale product processing.

**Apollo** designed and installed approximately 800 tonnes of structural steel and 50,000 linear metres of steel purlins, forming a core element of 4,000sqm of awnings, 42,000sqm of warehouse and large modern office space.



4.3 million



2021



FDC Constructions



800 Tonne





PROJECT:

# CAMPBELLTOWN HOSPITAL

CAMPBELLTOWN, NSW

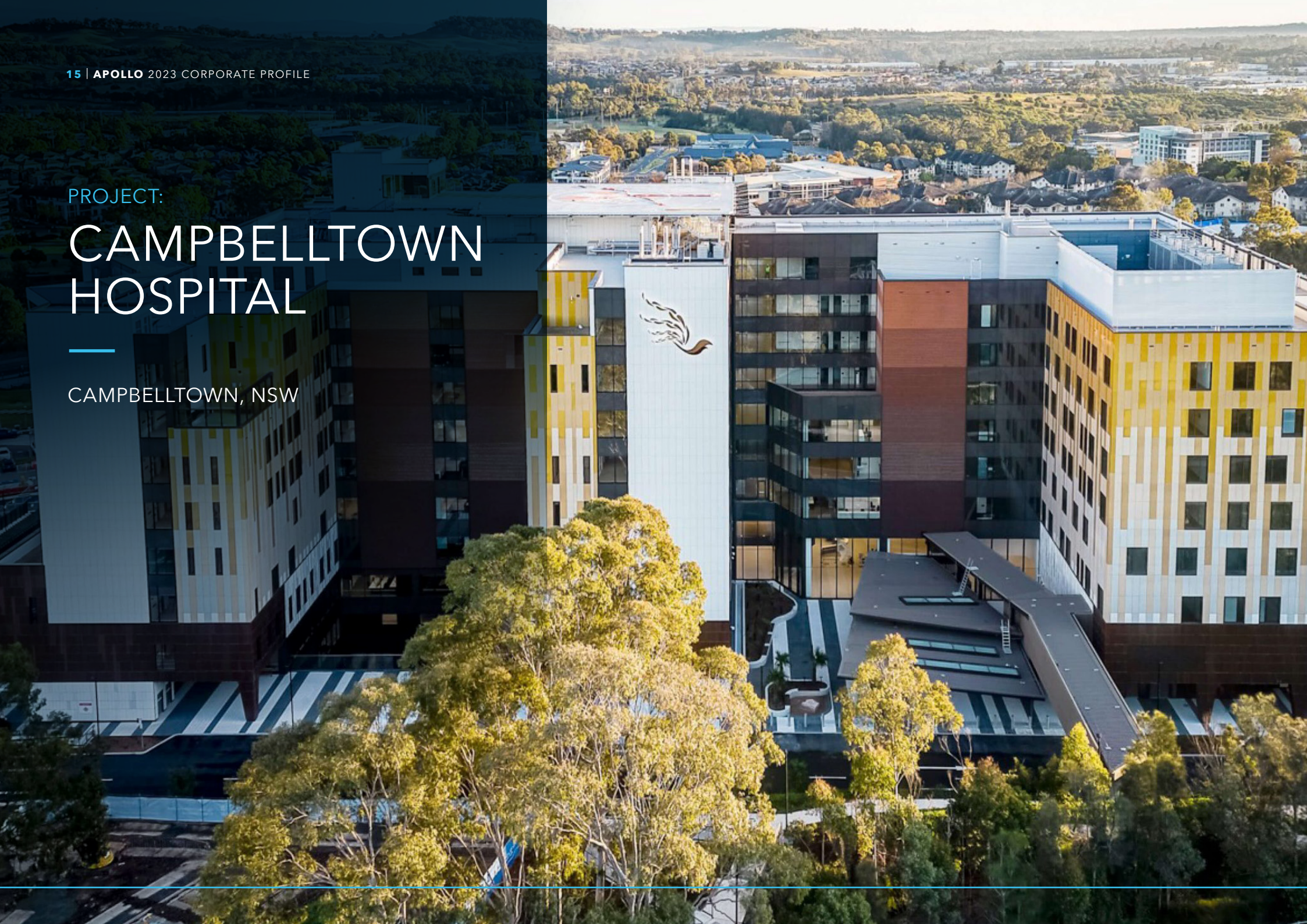



# CAMPBELLTOWN HOSPITAL

## SOPHISTICATED ARCHITECTURAL STEEL AND FINISHES

**Campbelltown Hospital's** \$632 million, 12-storey hospital renovations double the facility's capacity. It features state-of-the-art operating theatres and expanded units for intensive care, mental health and women's and children's services.

**Apollo** was engaged to design and install 350 tonnes of complex steel structures coupled with specialist architectural coatings and protective finishes. The results speak for themselves



3.5 million



N/A



CPB Contractors



400 Tonne

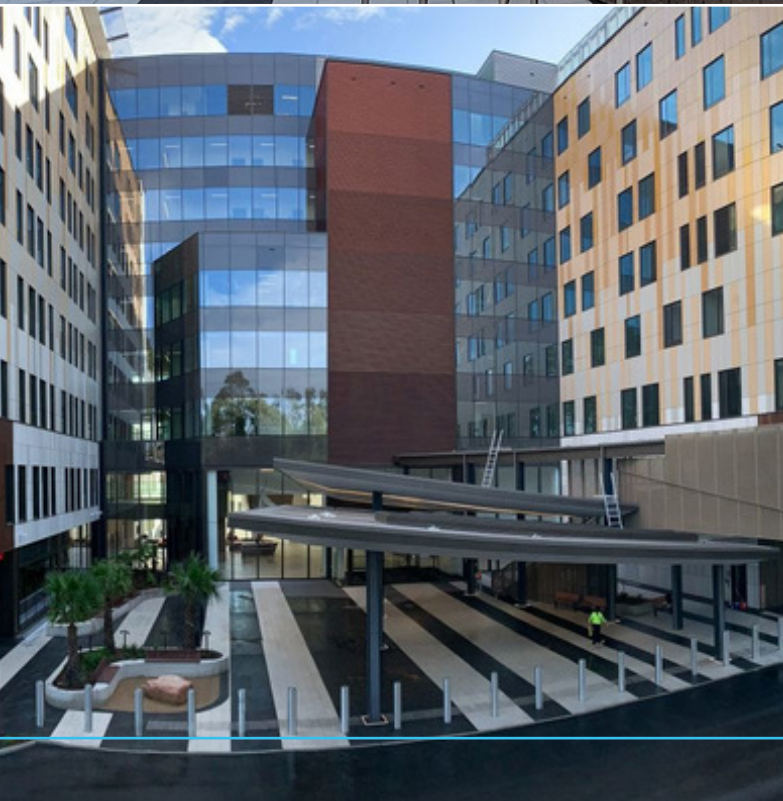



PROJECT:

# ANDREW BOYCE CHARLTON POOL

MANLY, NSW





# ANDREW BOYCE CHARLTON POOL

MULTI-AWARD WINNING  
AQUATIC CENTRE

**Andrew Boy Charlton Swim Centre** in Manly covers 5,500sqm including a 3,500sqm pool hall with a spa, leisure pool, program pool and 25m pool. It also boasts a 2,000sqm multi-storey office building with gym, amenities and crèche.

**Apollo** was engaged to execute the complicated steel structure and meet the required 15-year surface treatment warranty. We partnered with Dulux to apply a 3-coat paint system to protect the steel in the highly corrosive environment.

The project was awarded the Australian Steel Institute (ASI) NSW and ACT Steel Excellence Award, and the Master Builders Association of NSW (MBA) Best Sporting Facility.



2 million



2015 - 2016



FDC Constructions



200 Tonne





PROJECT:

# SIRIUS BUILDING

—  
SYDNEY, NSW







# SIRIUS BUILDING

## REVITALISING AN ICONIC SYDNEY LANDMARK

**The Sirius Building** is an iconic landmark sitting alongside Sydney Harbour Bridge with 360 degree views of the harbour and skyline. Originally built in the 1980s, it has been revitalised in a major development designed to protect its rich heritage while offering modern, luxury living.

**Apollo** is proud to partner on this project to deliver 600 tonnes of complex architectural steelwork involved in 35 new modular apartment pods, 120 balconies and hoods, and 4 lift steel cores.



6 million



2022 - 2023



Richard Crookes  
Constructions



N/A



PROJECT:

# AUSTRALIAN WAR MEMORIAL

CANBERRA, ACT





# AUSTRALIAN WAR MEMORIAL

BUILDING A LEGACY FOR GENERATIONS TO COME

The Australian War Memorial's \$550-million development project includes a new Anzac Hall featuring a glazed link with a translucent roof connecting the heritage building and new hall, an element to be built by Lend Lease.

Apollo was engaged by Lend Lease to partner with them to design, engineer, source, supply and install 800 tonnes of detailed and sophisticated architectural steelwork as part of their scope of works.



9 million



2023 - 2024



Lendlease



800 Tonne





PROJECT:

# AFP FORENSIC DATA CENTRE

MAJURA, ACT





# AFP FORENSIC DATA CENTRE

END-TO-END DESIGN, ENGINEERING AND DEVELOPMENT

**The AFP Forensics and Data Centre** is a 13,600 sqm state-of-the-art building located in Majura, Canberra. The purpose-built facility provides highly specialised spaces and a strict level of compliance to ensure the AFP maintains its world-class standards in forensic operations, forensic science policy, research and training.

**Apollo** was engaged to deliver 350 tonnes of structural steel as part of the project and were closely involved from design right through to installation. The building was awarded the Canberra Medallion at the ACT Architecture Awards.



2.6 million



2014 - 2015



Cockram  
Constructions



350 Tonne

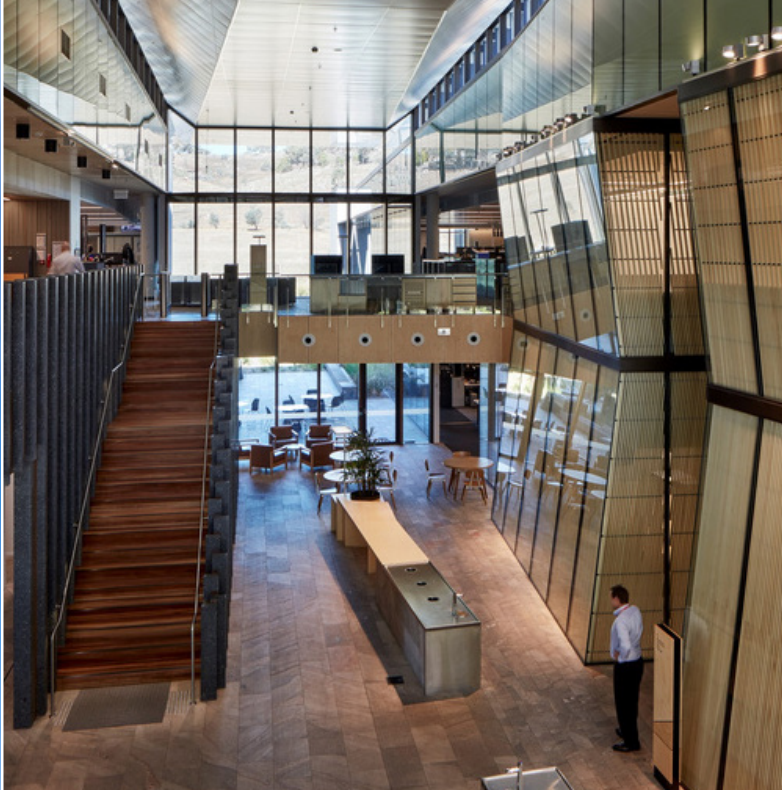



## CONTACT US

---

1800-007-662

(02) 6382 6844

[sales@apollofabrication.com.au](mailto:sales@apollofabrication.com.au)

[www.apollofabrication.com.au](http://www.apollofabrication.com.au)

## VISIT OUR OFFICE

**10-12 Telegraph Road**

Young NSW 2594

PO Box: 1539

